

View Series

technical specifications guide

### NAVIGATION:

Click on the text below to jump to that page. Click on the NxtWall Logo in the upper right corner on each page to return back to the table of contents.

### ELEVATION DIAGRAM & 3D VIEW

VIEW SYSTEM WALL ASSEMBLY DIAGRAM .....	3
VIEW SERIES WALL SECTION .....	4

### FULL HEIGHT GLASS ELEVATIONS

FULL HEIGHT FRAMELESS GLASS .....	5
SLIDING GLASS DOOR .....	6
CENTER GLASS START .....	7
SEAMLESS CORNER .....	8

### ANGLES

2 DIRECTION ANGLE WITH CORNERPOST .....	9
3 DIRECTION ANGLE WITH CORNERPOST .....	10
3 DIRECTION ANGLE WITH FLY BY .....	11

### DETAILS

FLOOR AND CEILING DETAILS .....	12
---------------------------------	----



# VIEW SERIES

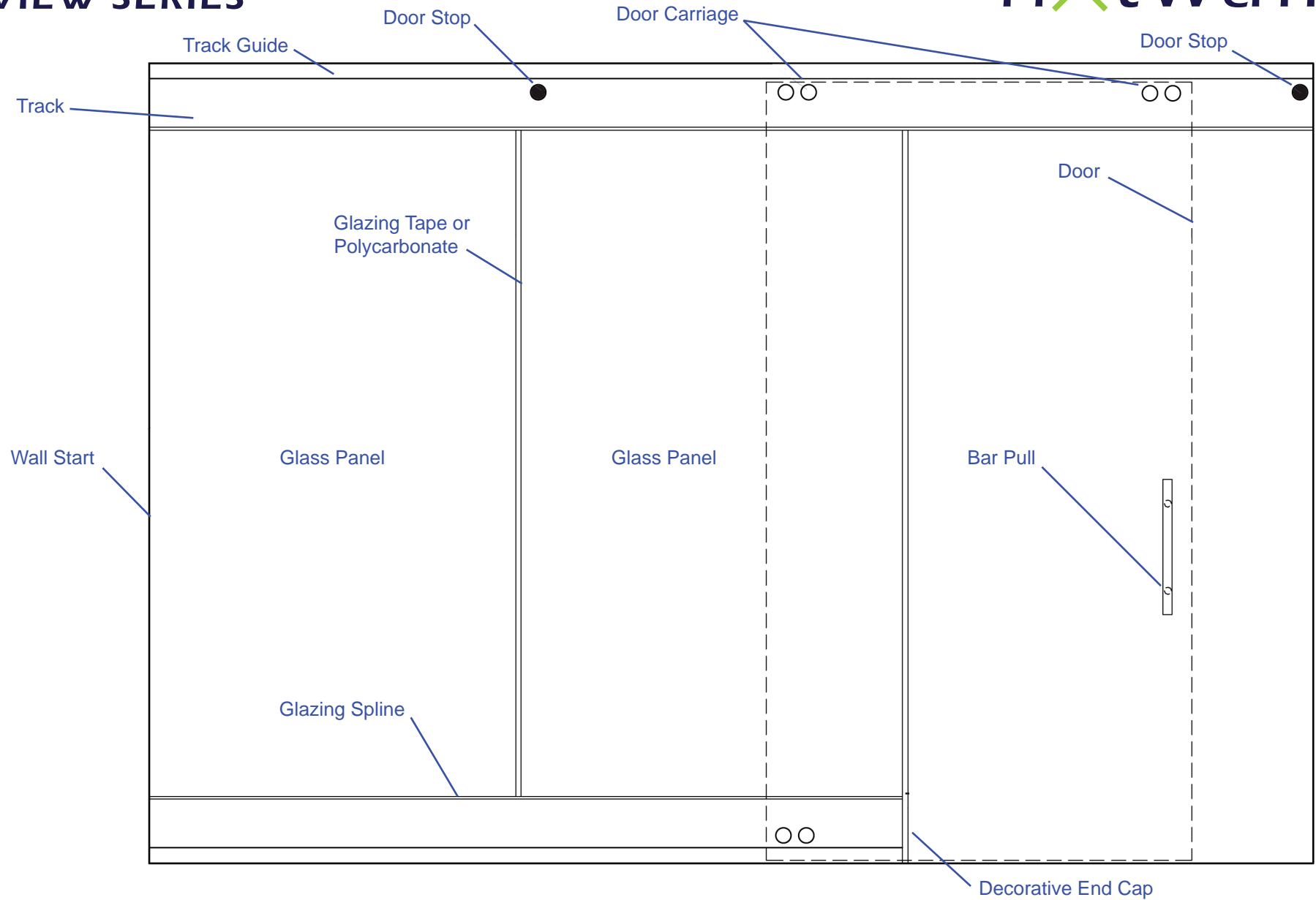

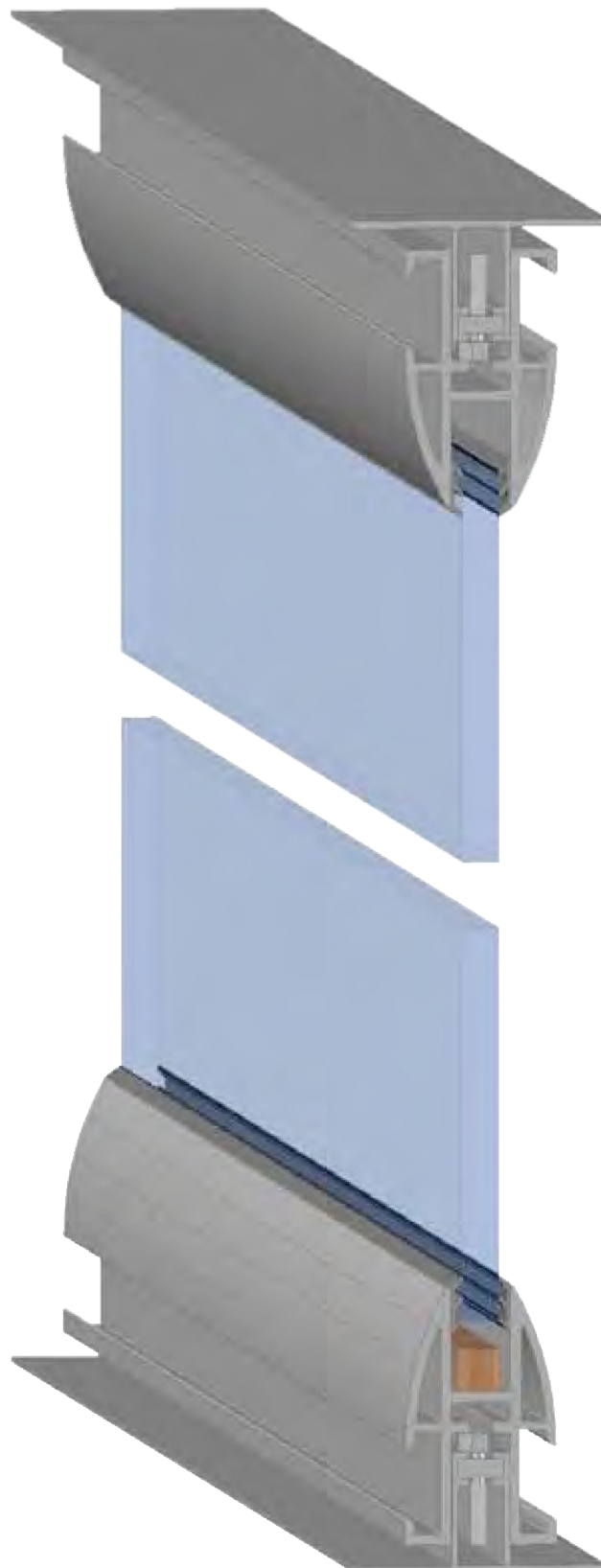

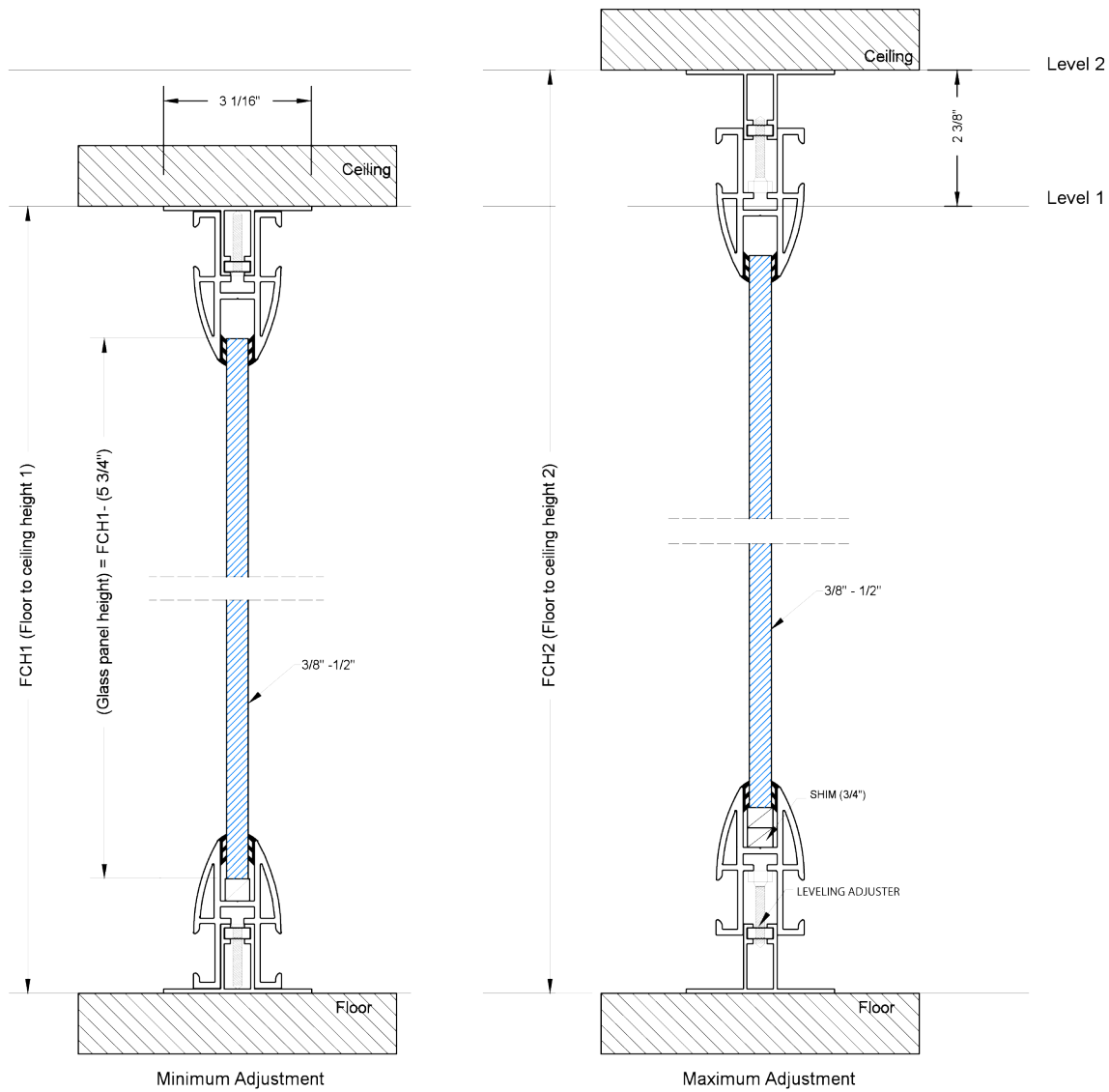

VERTICAL SECTION

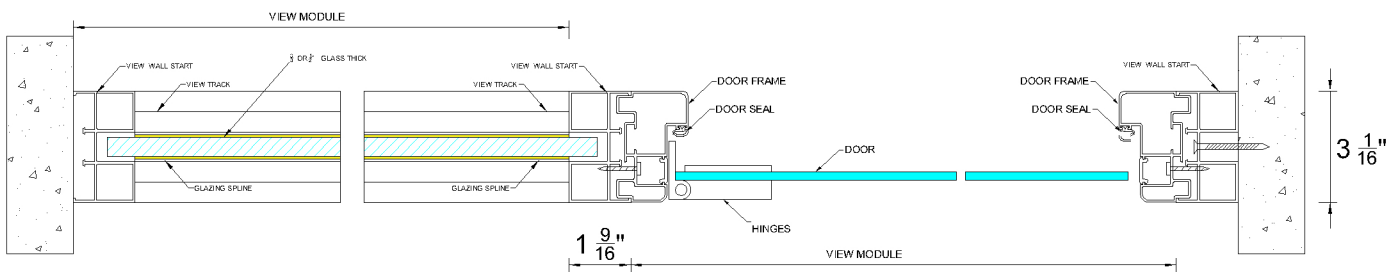

HORIZONTAL SECTION



# VIEW SERIES



\* Minimum Air Gap of 3/16" Required

\* Minimum Air Gap of 3/16" Required

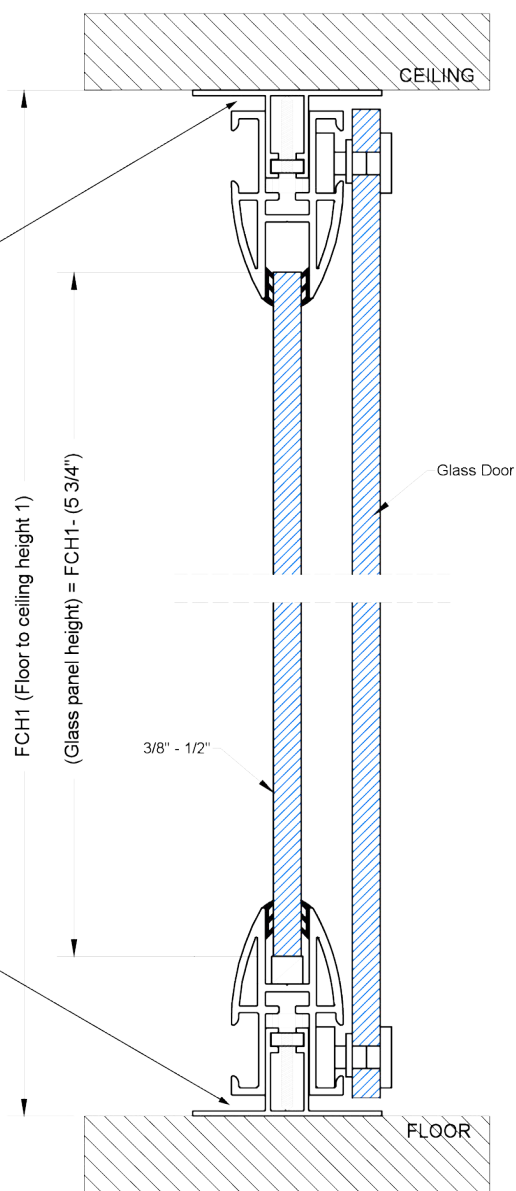

VERTICAL SECTION

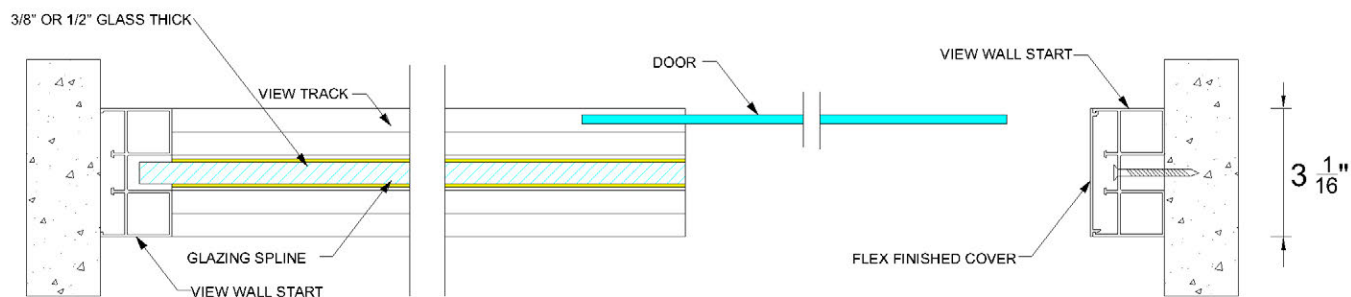

HORIZONTAL SECTION

## SWING DOOR CENTERED GLASS

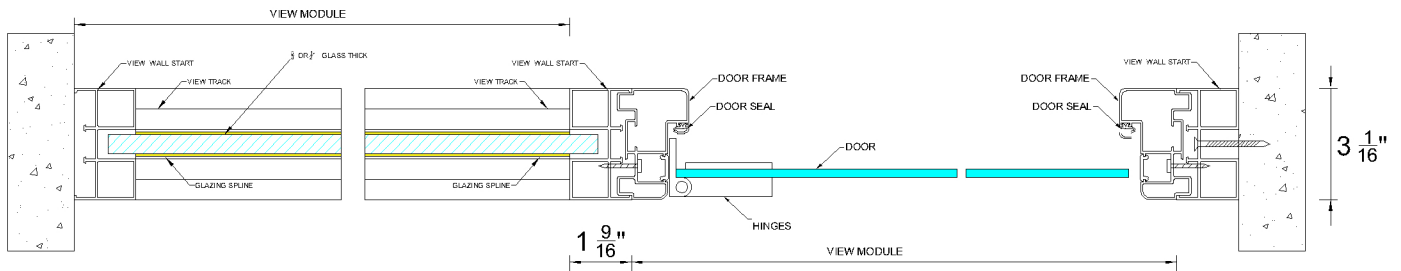

## SLIDING DOOR CENTERED GLASS

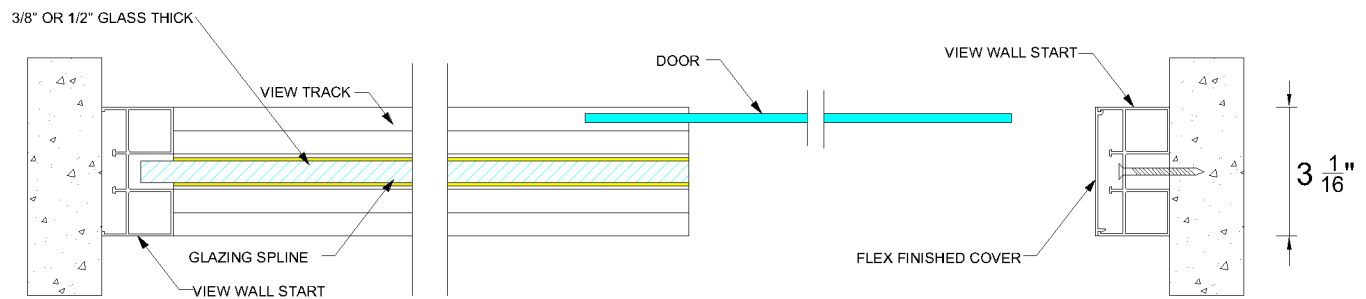

## SLIDING DOOR VENTERED GLASS (FREE STANDING)

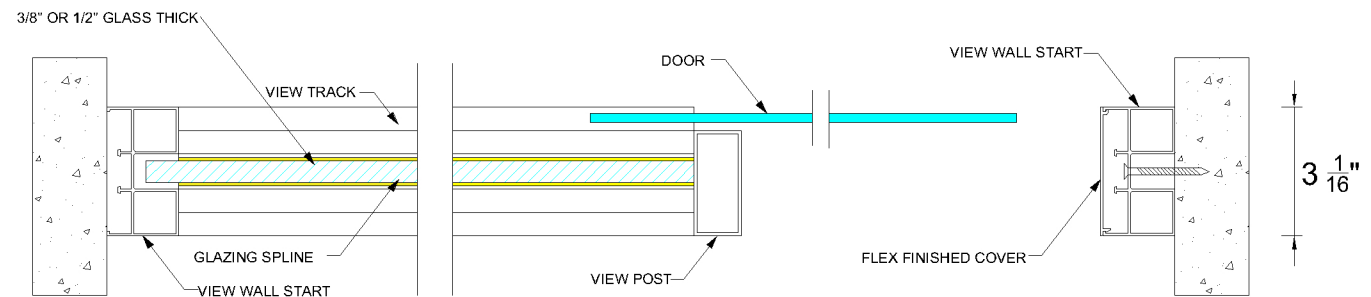

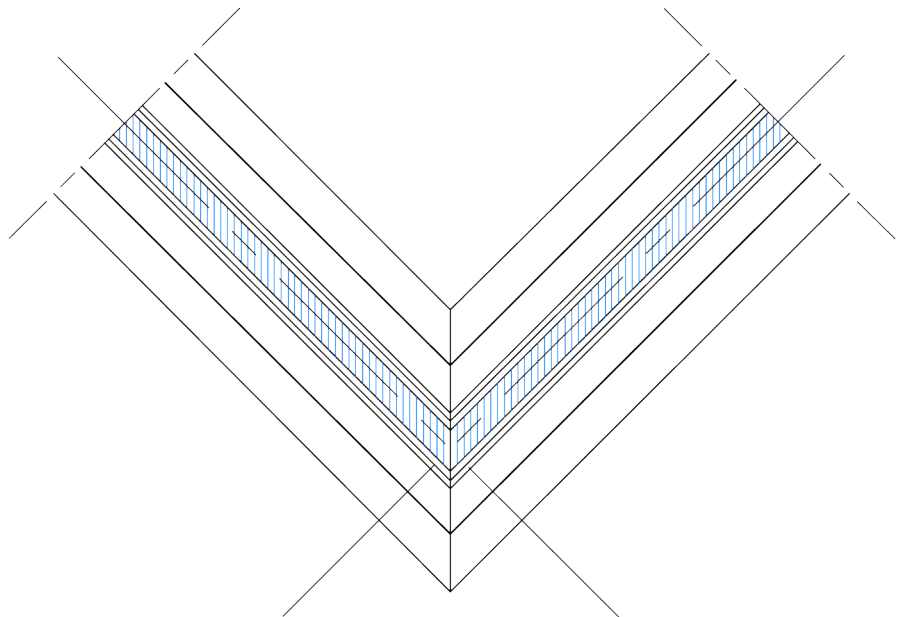
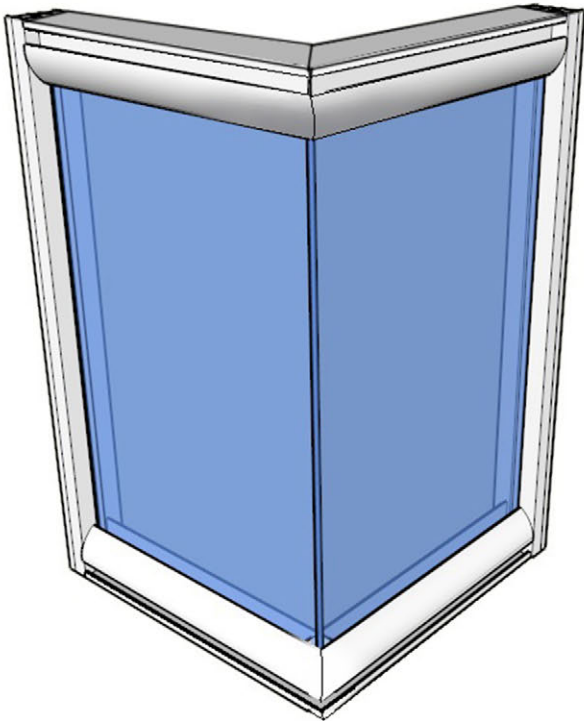



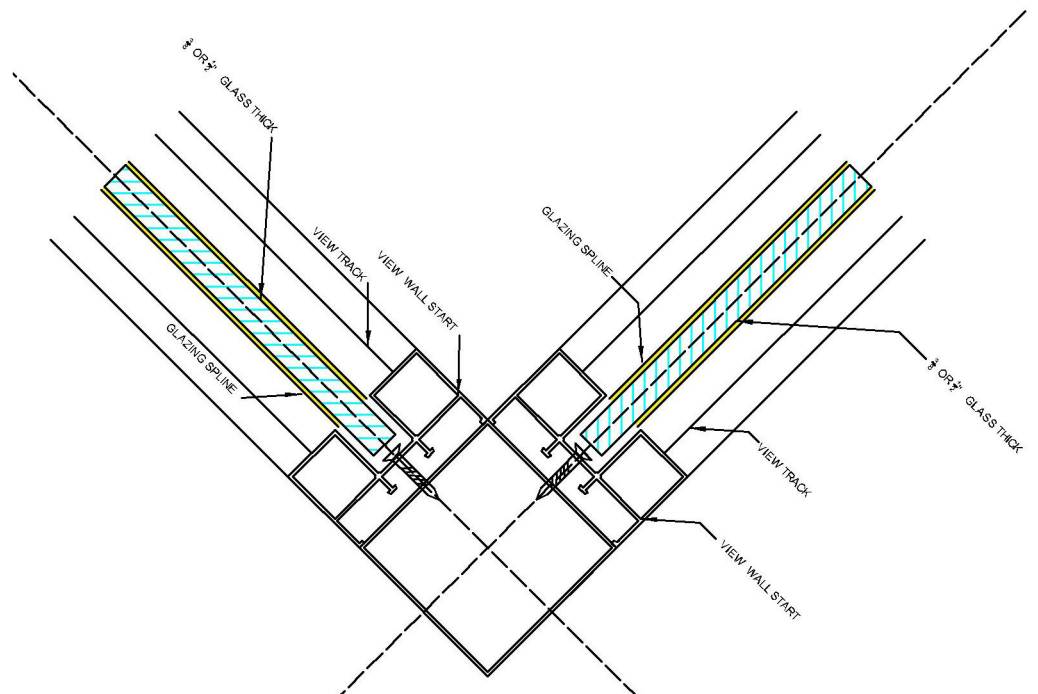
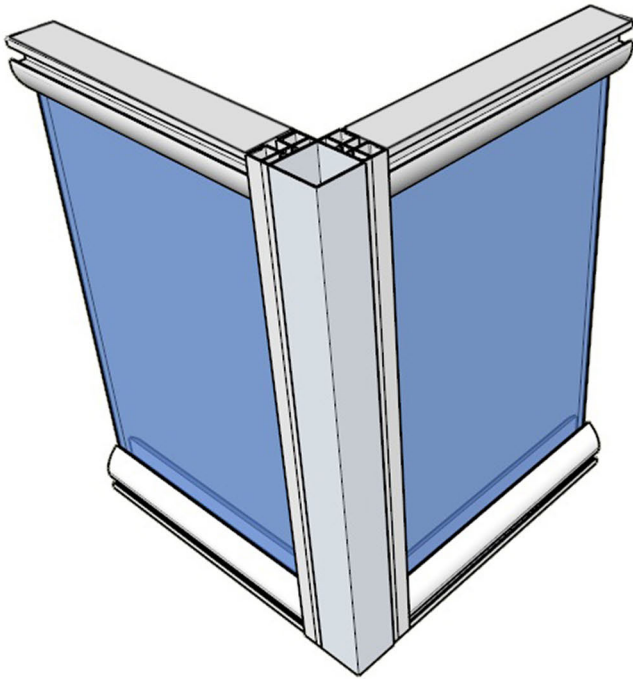

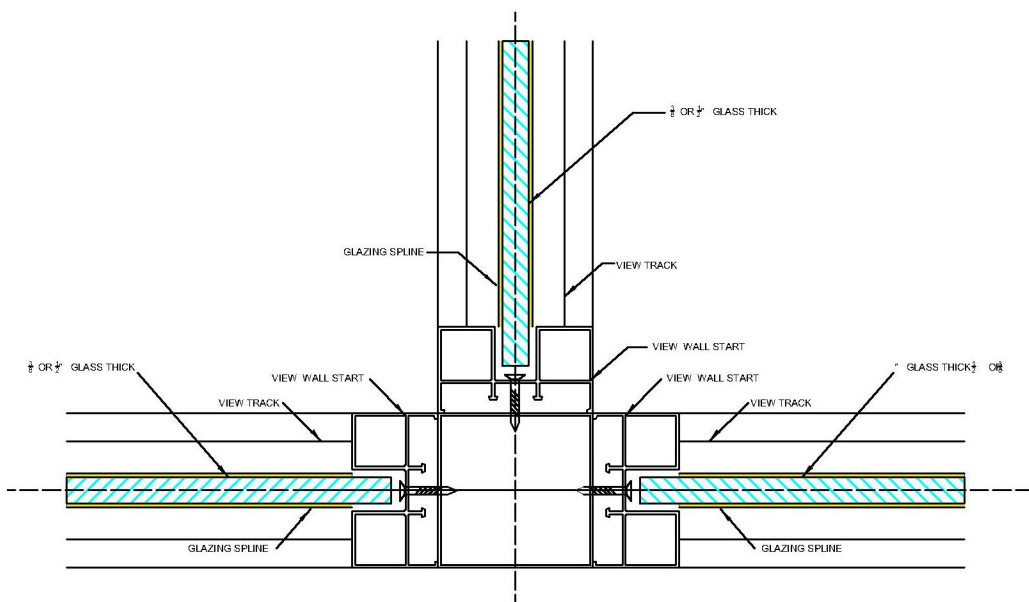
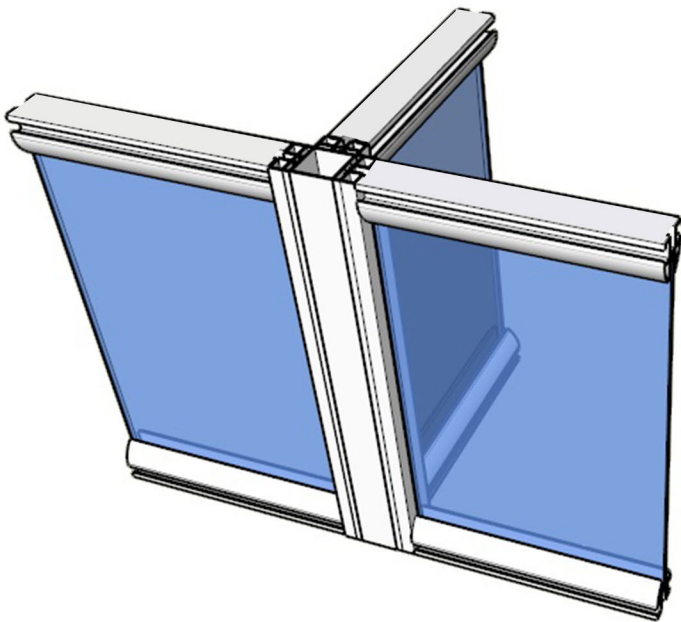

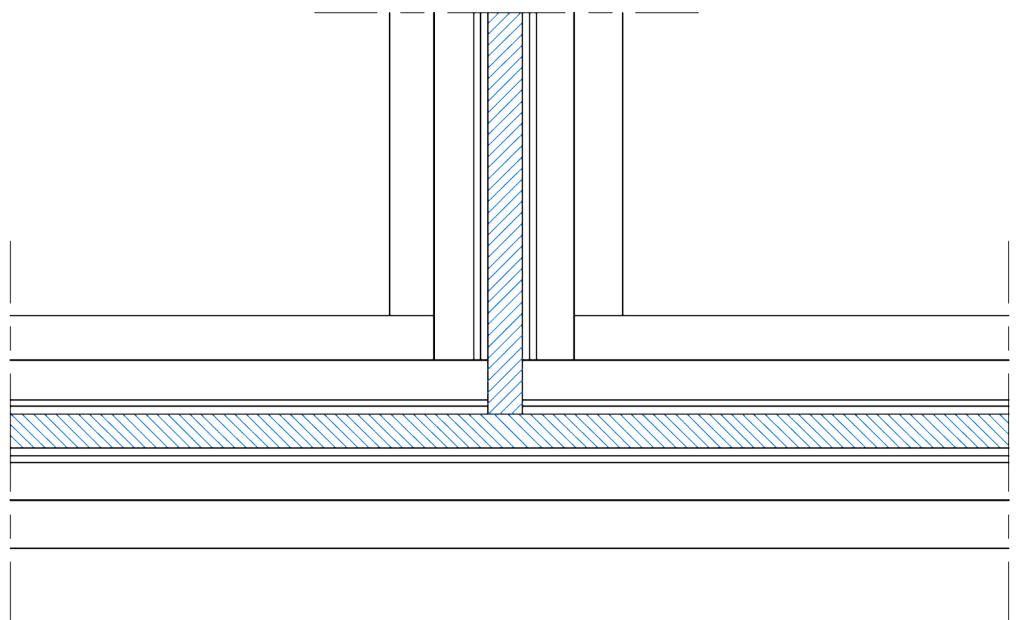
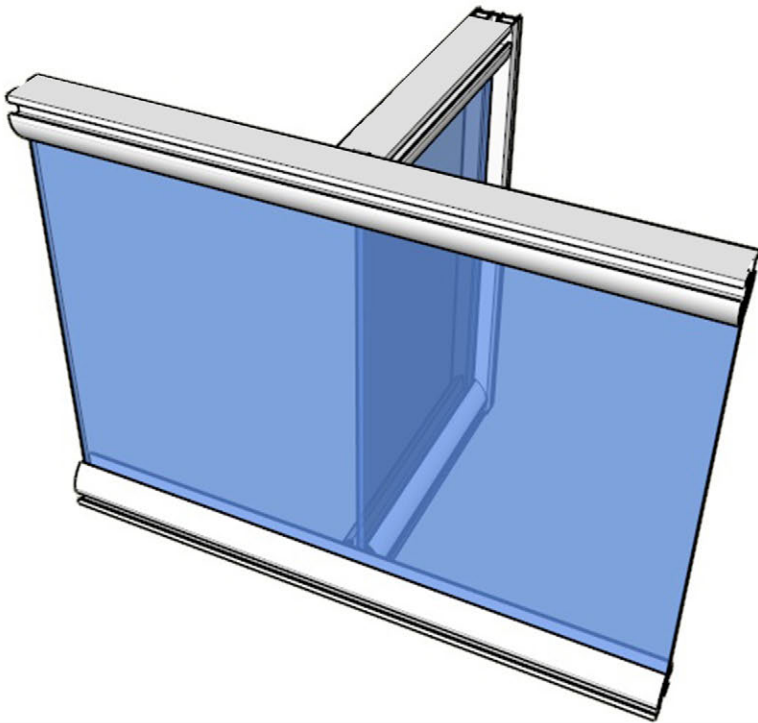

NW 78-36 View Track Guide

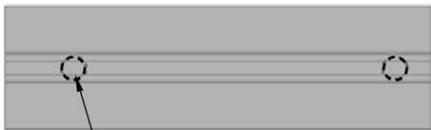

Drill out with .050 Drill Bit every 2'

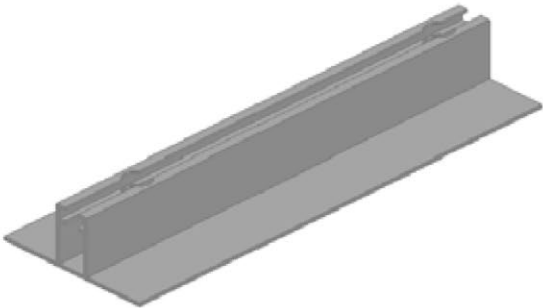

Step 1:

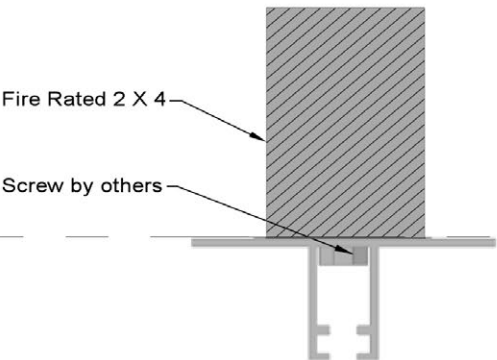

To support overhead load support stud must be installed above drop ceiling grid with screws

Step 2:

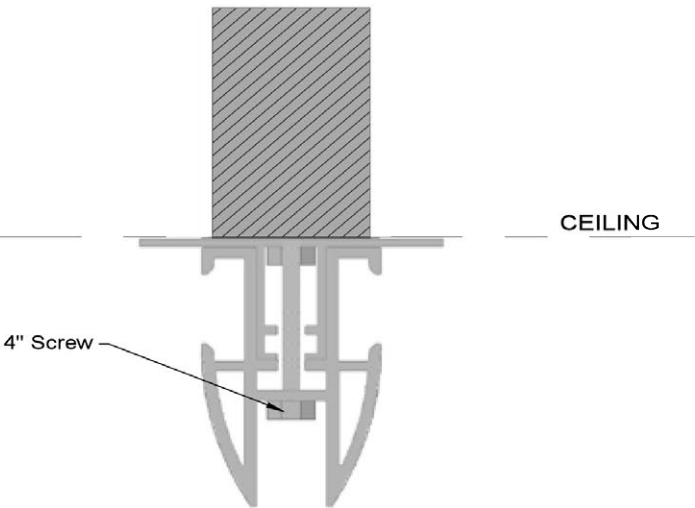

FLOOR

