



Swing Door Installation

(Wood Door & Aluminum Framed Door)

Swing Door Installation (Wood Door & Aluminum Framed Door)

Materials – Hinge Assembly Kit:

Note: The hinge assembly kit is the same for Wood Doors and Aluminum Framed Glass Doors.

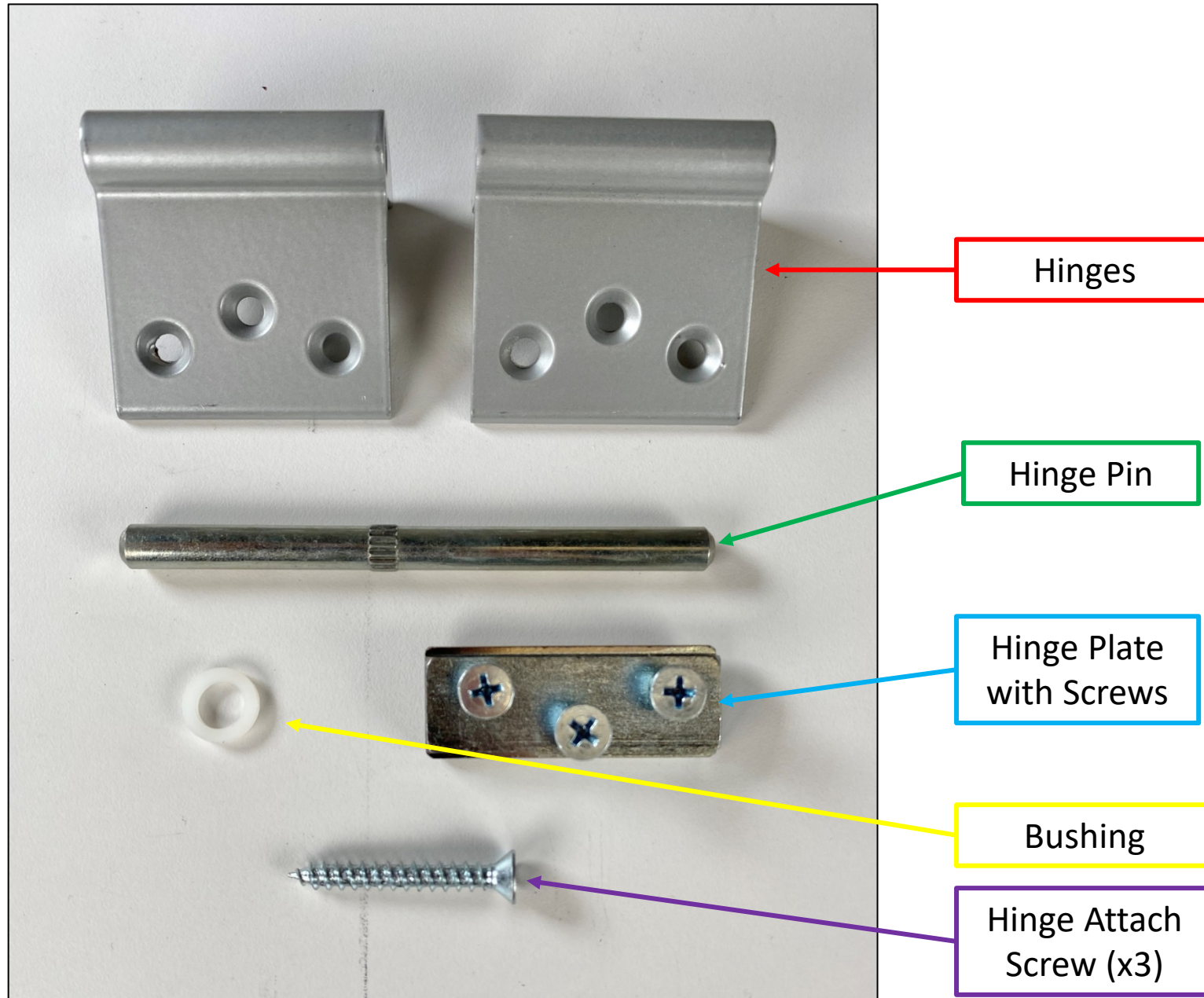

Swing Door Installation (Wood Door & Aluminum Framed Door)

Hinge Assembly:

On the Hinge Pin the Knurling is not centered. When the Hinge Pin is inserted into the Hinge half put the short side of the pin down, see photo for reference.

After placing the pin in the hinge use a hammer to gently tap the knurled part of the pin into the hinge until the pin is flush with the bottom of the hinge.

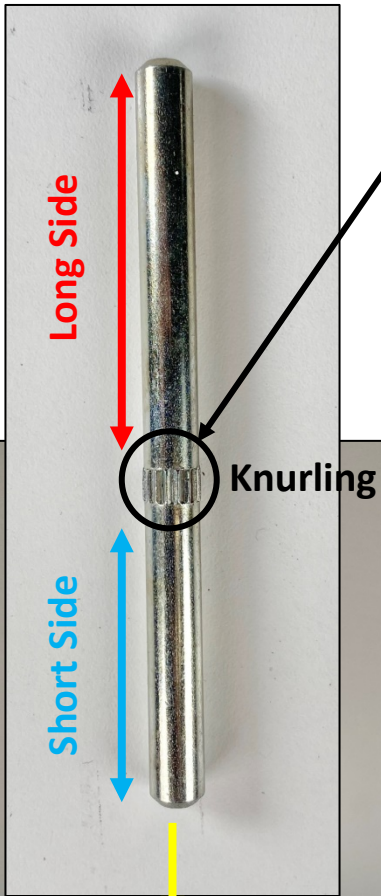

1.



2.



Please Note:
Make sure the swing direction of the door is known prior to installing the Hinge Pins.

3.

Swing Door Installation (Wood Door & Aluminum Framed Door)

Attaching Hinge to Door Jamb:



Attach the Hinge half with the Hinge Pins onto the Door Jamb. To attach, remove the preinstalled set screws from the Hinge Plate, align the holes of the Hinge to the Hinge Plate. Re-install the set screws. Tighten the set screws to hold the hinge in place. Exact location of the hinge will be set once the door is on the hinges.

For standard height doors (7') there will be 3 Hinges. Any doors over 7' will receive 4 Hinges.



Swing Door Installation (Wood Door & Aluminum Framed Door)

Door Preparation:

Please Note: Make sure the swing direction of the door is known prior to attaching the Hinges.

Spacing for the Hinges are 6" from the top of the door, and 6" from the bottom of the door. Center or equally space the Hinges between the top and bottom hinge.

Find the top of the door. The hinges will go above the marked locations towards the top of the door.

When installing the Hinges on to the door (for both Wood or Aluminum Framed), use a 5/32" drill bit to pre-drill each hole before attaching the Hinge. Make sure the Hinge is tight to the door prior to drilling the holes, see photo below for reference. Attach the Hinge to the door using the provided screws.



Important: Hinge must be tight to the door



Swing Door Installation (Wood Door & Aluminum Framed Door)

Installing the Door:

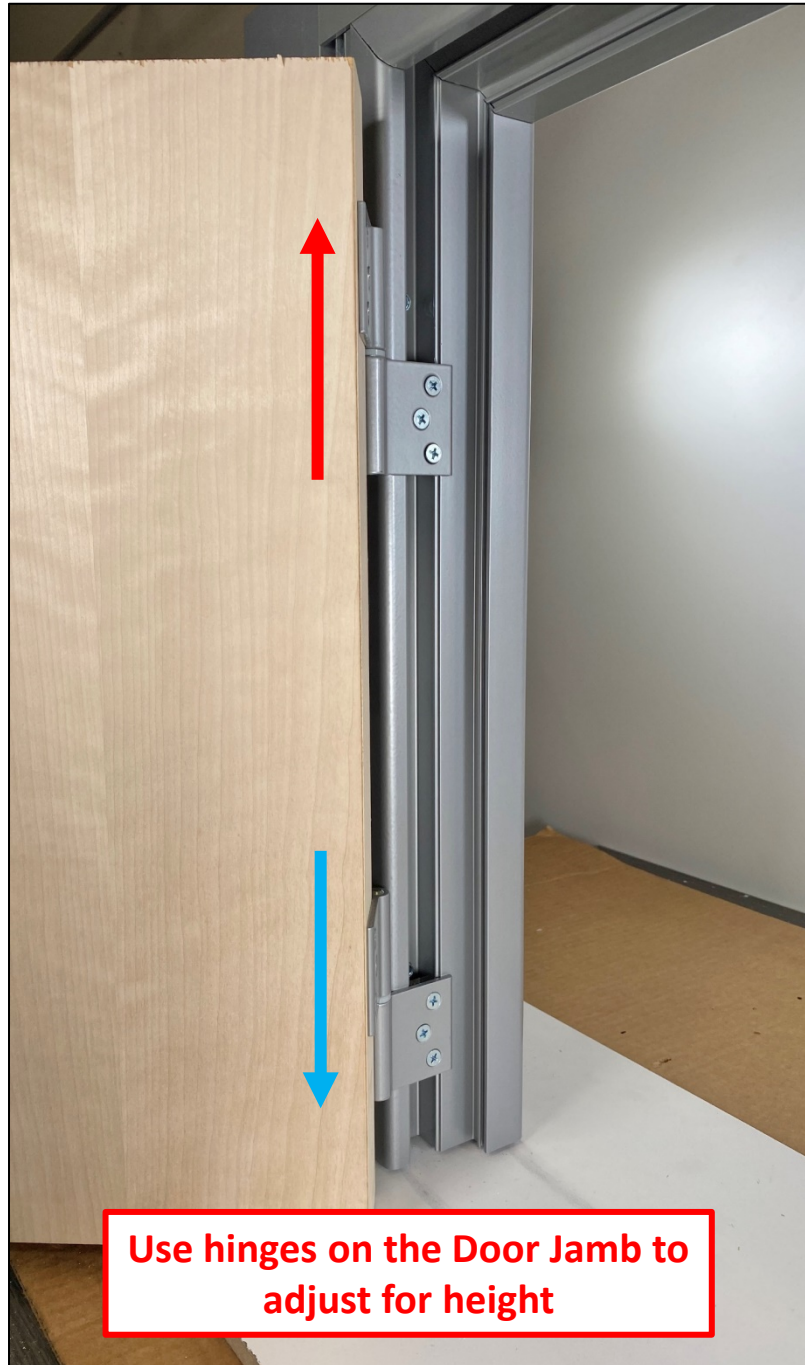

Hanging the Door:

1. Align the Hinges on the door with the Hinges on the Door Jamb.
2. Loosen the set screws on the Hinge attached to the Door Jamb.
3. Slide the Door Jamb side Hinge into the Hinge on the door. Repeat for all Hinges.
4. Once all Hinges are lined up adjust the door to the desired height. ***Note: The doors should have a 1/2" between the bottom of the door and the floor.***
5. With the door in the correct position tighten all three set screws on the hinge to anchor the door in place.
6. Install the remaining door hardware, door jamb rubber, door strike rubber, and strike plate.
7. Door installation is complete.